

Franklyn Street

ST PAULS

APPROXIMATE FLOOR AREA
91.9 SQM / 989 SQFT

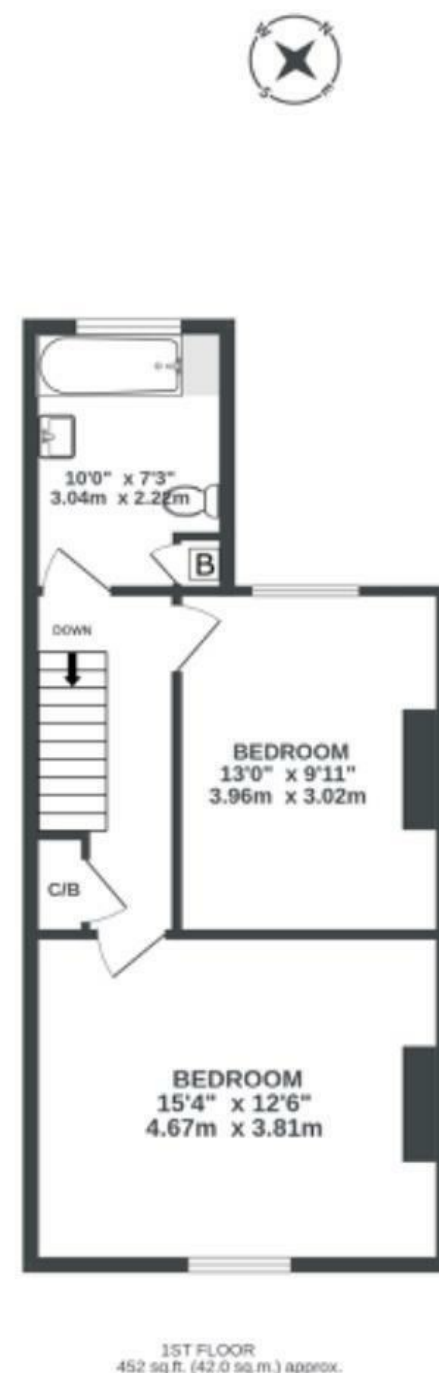

Illustrations are for reference purposes only, measurements are approximate, not to scale.

Boardwalk

Franklyn Street , BRISTOL



£400,000



Bristol, BS2

91 A



2 Bedrooms



1 Bathrooms

"We have loved our time on Franklyn Street, and the labour of love to make the house our own, installing a new kitchen and bathroom, restoring Victorian features and landscaping the garden. It's close to town, Gloucester Road and Stokes Croft, with loads of independent restaurants and bars in walking distance. It's a really friendly street with an active WhatsApp chat. The beautiful back garden has been a peaceful green oasis amongst the hustle and bustle of the city."

